

# Ashland EARTHMOVERS

## TRACTOR DRAWBARS

*Tractor Drawbars for Ashland Industries  
Direct-Mounted Earthmovers*

*Revised  
July 22, 2009*

filename: Drawbar Pricebook 07-2009.pmd

Ashland Industries Inc.  
1115 Rail Drive  
P.O. Box 717  
Ashland, WI. 54806  
Ph: 877-634-4622 *Toll Free*  
Ph: 715-682-4622  
Fx: 715-682-9717  
[www.ashlandind.com](http://www.ashlandind.com)



# *Tractor Drawbars*

*Tractor Drawbars for Ashland Industries Direct-Mounted Earthmovers*

<i>Allis Chalmers (AGCO)</i>	<i>Page 3</i>
<i>Bell</i>	<i>Page 3</i>
<i>Bueller - Versatile</i>	<i>Page 4</i>
<i>Case</i>	<i>Page 5</i>
<i>Case International</i>	<i>Page 6</i>
<i>Case I.H. Steiger</i>	<i>Page 7</i>
<i>Catepillar</i>	<i>Page 8</i>
<i>Fendt</i>	<i>Page 9</i>
<i>Ford - New Holland</i>	<i>Page 10</i>
<i>John Deere</i>	<i>Page 11</i>
<i>Komatsu</i>	<i>Page 12</i>
<i>Kubota</i>	<i>Page 12</i>
<i>Massey Ferguson</i>	<i>Page 13</i>
<i>Oliver</i>	<i>Page 14</i>
<i>Rome Tractor</i>	<i>Page 15</i>
<i>Steiger (prior to Case I.H.)</i>	<i>Page 16</i>
<i>White</i>	<i>Page 17</i>
<i>Woods &amp; Copeland / Rome</i>	<i>Page 18</i>
<i>Versatile</i>	<i>Page 19</i>
<i>Volvo</i>	<i>Page 19</i>

Prices & Specifications are subject to change without advanced notice.  
All prices are in U.S. Dollars, F.O.B. Ashland, Wisconsin.  
Drawbars will only receive current Parts Level Discounts.

# ALLIS CHALMERS & BELL

## *Tractor Drawbars for Ashland Industries Direct-Mounted Earthmovers*

Replaces standard tractor Drawbars with heavy-duty earthmover Drawbars to receive the 3-way adjustable yoke style hitch. Some Drawbars will also come included with modified hanger brackets. These Drawbars will range from a two ear to a four ear horizontal 1-1/2" pinning configuration. Contact your local tractor dealer to fully understand the tractors warranty while pulling direct-mount earthmovers.

### ALLIS CHALMERS "AGCO"

Ashland Part No.	Applications	Weight	Price
DB-C525	Model 440	275	\$706.00
DB-C543	Models 7000, 7010, 200	105	\$435.00
DB-C540	Models 7040, 7060, 7080, 7580, 8010, 8030, 8050	145	\$488.00
DB-C961	Model 8550, 8775, 8785	200	\$694.00
DB-1060802	Models 9630, 9650, 9670, 9690, 9635, 9655, 9675, 9695	85	\$547.00
DB-1062794-01	Models 9765, 9775, 9785	114	\$618.00
DB-1004	Model DT-160	118	\$420.00
DB-1003	Models: DT-180, DT-200, DT-225	120	\$425.00
DB-788	Drawbar Adapter, Converts back to Std. Double lip hitch	80	\$429.00
DB-788A	Drawbar Adapter complete with 2" drawpin & Pin Keeper	89	\$665.00

### BELL

Ashland Part No.	Applications	Weight	Price
DB-1067250	(4) Ear Drawbar for models 4206D & 4206DT		CALL FOR PRICING

Prices & Specifications are subject to change without advanced notice.  
All prices are in U.S. Dollars, F.O.B. Ashland, Wisconsin.  
Drawbars will only receive current Parts Level Discounts.

# Bueller Versatile

## Tractor Drawbars for Ashland Industries Direct-Mounted Earthmovers

Replaces standard tractor Drawbars with heavy-duty earthmover Drawbars to receive the 3-way adjustable yoke style hitch. Some Drawbars will also come included with modified hanger brackets. These Drawbars will range from a two ear to a four ear horizontal 1-1/2" pinning configuration. Contact your local tractor dealer to fully understand the tractors warranty while pulling direct-mount earthmovers.

### Bueller

Ashland Part No.	Model Number	Weight	List Price
DB-1060765	2210, 2180, 2160, 2145 "same as Genesis Serise MFWD"	141	\$571.00
DB-1007	2240 2290, 2335, 2375, 2360, 2425, (Drawbar & Hanger only) Ford, New Holland Versatile Models: 9480, 9680, 9880,9482 9484, 9682, 9684 (with or without 3-pt)	615	\$2,794.00

*Special Note: Bueller recommends for high demand use to purchase a scraper ready tractor from authorized Buhler dealer*

Older Versatile tractors can be found within the **Versatile** Category.

Prices & Specifications are subject to change without advanced notice.

All prices are in U.S. Dollars, F.O.B. Ashland, Wisconsin.

Drawbars will only receive current Parts Level Discounts.

*Tractor Drawbars for Ashland Industries Direct-Mounted Earthmovers*

Replaces standard tractor Drawbars with heavy-duty earthmover Drawbars to receive the 3-way adjustable yoke style hitch. Some Drawbars will also come included with modified hanger brackets. These Drawbars will range from a two ear to a four ear horizontal 1-1/2" pinning configuration. Contact your local tractor dealer to fully understand the tractors warranty while pulling direct-mount earthmovers.

**CASE**

<b>Ashland Part No.</b>	<b>Model Number</b>	<b>Weight</b>	<b>List Price</b>
DB-C465	Models 930, 1030, 1070, 1090	115	\$465.00
DB-C516	Model 1270 - Drawbar Adapter	95	\$394.00
DB-C522	Models 1370, 1570, 2390, 2590	190	\$824.00
DB-C518	Models 1470, 2470, 2670, 4490, 4690	95	\$565.00
DB-1044193	Model 3294	130	\$353.00
DB-D464	Models 2870, 4890, 4894	100	\$582.00
DB-1041810	Model 4994	481	\$1,176.00
DB-1020758	Models 2090, 2290, 2294	140	\$553.00
DB-1051793	Models 2390, 2394, 2590, 2594, 3296, 3394, 3594	100	\$300.00
DB-788	Drawbar Adapter, Converts back to Std. Double lip hitch	80	\$429.00
DB-788A	Drawbar Adapter complete with 2" drawpin & Pin Keeper	89	\$665.00

*Also see: Case IH, Case IH Steiger*

Prices & Specifications are subject to change without advanced notice.  
All prices are in U.S. Dollars, F.O.B. Ashland, Wisconsin.  
Drawbars will only receive current Parts Level Discounts.

# CASE - INTERNATIONAL

## Tractor Drawbars for Ashland Industries Direct-Mounted Earthmovers

Replaces standard tractor Drawbars with heavy-duty earthmover Drawbars to receive the 3-way adjustable yoke style hitch. Some Drawbars will also come included with modified hanger brackets. These Drawbars will range from a two ear to a four ear horizontal 1-1/2" pinning configuration. Contact your local tractor dealer to fully understand the tractors warranty while pulling direct-mount earthmovers.

### CASE - INTERNATIONAL

Ashland Part No.	Application	Weight	Price
DB-C175	Models 806, 826, 856, 966, 1026	75	\$306.00
DB-C176	Models 1206, 1256, 1456	135	\$394.00
DB-C537	Models 1066, 1466, 1468, 1566, 1568	130	\$394.00
DB-C784	Models 886, 986, 1086, 1486, 1586	125	\$400.00
DB-C523	Model 4166	105	\$529.00
DB-D475	Models 4366, 4386, 4566, 4568, 4586, 4786	275	\$788.00
DB-986	Models 3388, 3588, 3788	130	\$429.00
DB-1026129	Models 5088, 5288, 5488, 7110, 7120, 7130, 7140, 7150, 8650, 8900, 8940, 8950.	117	\$518.00
DB-1060801	Models 5120, 5130, 5140, 5220, 5230, 5240, 5250	85	\$547.00
DB-1062179-01	Magnum Series, <b>two</b> ear drawbar. (except for France, Germany, Italy) 180, 200, 210, 220, 230, 240, 255, 270, 275 & 285	115	\$518.00
DB-600117	Magnum Series, <b>four</b> ear drawbar. Applicable to all countries (Note: North American std. version cat. 3 drawbar. <b>(uses 35mm belly-pin)</b> )		
Magnum Models 180, 190, 200, 210, 215, 220, 225, 230, 240, 245, 250, 255, 270, 275, 280, 285, 305, 310 & 335			\$ to be determined
DB-600116	Magnum Series, North America with Heavy Duty optional category 4 drawbar, <b>(uses 44mm belly-pin)</b> Magnum MX-Series 180, 190, 210, 215, 245, 275, 305, 335 (only available in North America)		\$ to be determined
DB-1062294-01	Models: MX150, MX170	112	\$410.00
DB-1062323-01	Models: MX 100, MX 110, MX120, MX135	88	\$380.00
DB-1065710	(2) Ear DB for models MXM165, MXM175, MXM140		CALL FOR PRICING
DB-1066305	Models: 9270, 9280, 9290, 9370, 9380, 9390 w/o 3-pt hitch (S/N JCB0003600 - JE0027095)		CALL FOR PRICING
DB-1066327	(2) Ear DB for models MXM110, 120, 130, 140, 155		CALL FOR PRICING
DB-1067390	(4) Ear DB for STX375 & STX500 w/1100 x 44 x 46 Tires only		CALL FOR PRICING

Prices & Specifications are subject to change without advanced notice.

All prices are in U.S. Dollars, F.O.B. Ashland, Wisconsin.  
Drawbars will only receive current Parts Level Discounts.

## Tractor Drawbars for Ashland Industries Direct-Mounted Earthmovers

Replaces standard tractor Drawbars with heavy-duty earthmover Drawbars to receive the 3-way adjustable yoke style hitch. Some Drawbars will also come included with modified hanger brackets. These Drawbars will range from a two ear to a four ear horizontal 1-1/2" pinning configuration. Contact your local tractor dealer to fully understand the tractors warranty while pulling direct-mount earthmovers.

### STEIGER-CASE I-H

Ashland Part No.	Application	Weight	Price
DB-1058879	Model 9110, 9130	960	\$2,024.00
DB-1058907	Model 9150, 9250 w/o 3-pt. Hitch	Use DB-1060610	
DB-1029322	Model 9170, 9180 S/N 17900650 to JCB 003599 DB Kit w/o 3-pt.	1045	\$1,947.00
DB-1061733	Models 9250, 9350 w/o 3-pt. S/N JCB0028400 & Higher	830	\$2,341.00
DB-1060610	Models 9150 - 9380 w/Adjustable Drawbar and 3-pt. (except on 9350) (Short 2-Ear Stub for 1.75" tractor pin)	128	\$965.00
DB-1060489	Models 9171, 9180, 9270, 9280, S/N JCB 3600 - JCB 0027095 DB Kit w/o 3-pt. Hitch	675	\$1,900.00
DB-1060499	Models 9270, 9280 w/o 3-pt. "Ears Up Only" S/N JCB0027096 TO JEE0069307 Recommended w/38" tires and smaller	820	\$2,124.00
DB-1060771	Models 9270, 9280, 9370, 9380 w/o 3-pt. "Ears Down Only" S/N JCB 0027096 to JEE0069307 Recommended w/42" tires and larger	870	\$2,359.00
DB-1060885	Models 9270, 9280, 9370, 9380, 9390 w/o 3-pt. "Ears Down Only" after S/N JEE0069307	870	\$2,259.00
DB-1060795	Models 9370, 9380 "Quad Trac" w/o 3-pt. Hitch	874	\$2,229.00
DB-1061734	Models 9370, 9380 Quad-Trac w/3 pt. Hitch	550	\$1,612.00
DB-1061733	Models 9250, 9350 w/o 3-pt. S/N JCB0028400 up	830	\$2,341.00
DB-1061739	Model STX 325, 375, 425, 440, 450, 500 Wheel Quad Tractors	1084	\$2,824.00
DB-1068739	Models STX 335, 385, 435, 485, 535 New Style Short		\$3,600.00
DB-1068579	Models STX 335 <b>Swing plate out Belly pin</b>		\$????
DB-1064220	Models STX 375, 440 DB kit		
DB-1066410	Models 9270, 9280, 9290, 9370, 9380 - S/N JEE0069308 & up		
DB-123339	"Stubby" Std Drawbar for Receiver Hitch 2" thick x 5" wide, Tube Type (Not Recommended for long term application)		\$371.00
DB-123339-01	"Stubby" Std Drawbar for Receiver Hitch 2" thick x 5" wide, Tube Type Hitch, strapping plate support, bushings and bolts for s.n. JEE 0099502 and above		\$706.00
DB-1009	"Stubby" Std Drawbar for Receiver Hitch 2" thick x 5" wide, 2 Ear Type		\$741.00
DB-123342	"Stubby" H.D. DB for Receiver Hitch 2.25" thick x 6" wide, Tube Type Hitch only		\$400.00
DB-123342-01	"Stubby" H.D. DB for Receiver Hitch 2.25" thick x 6" wide, Tube Type Hitch, strapping plate support, bushings and bolts		\$640.00
DB-1010	"Stubby" H.D. Drawbar for Receiver Hitch 2.25" thick x 6" wide, 2 Ear Type Hitch, strapping plate support, bushings and bolts		\$788.00
DB-788	Drawbar Adapter, Converts back to Std. Double lip hitch	80	\$429.00
DB-788A	Drawbar Adapter complete with 2" drawpin & Pin Keeper	89	\$665.00

**Also see:** Steiger Tractors page (prior to Case IH purchase)

# CATEPILLAR

## Tractor Drawbars for Ashland Industries Direct-Mounted Earthmovers

Replaces standard tractor Drawbars with heavy-duty earthmover Drawbars to receive the 3-way adjustable yoke style hitch. Some Drawbars will also come included with modified hanger brackets. These Drawbars will range from a two ear to a four ear horizontal 1-1/2" pinning configuration. Contact your local tractor dealer to fully understand the tractors warranty while pulling direct-mount earthmovers.

### CATEPILLAR

Ashland Part No.	Application	Approx. Weight	Price
DB-C534	Models D5 & D6 Drawbar Adapter	100	\$541.00
DB-C625	Model D5SA	115	\$588.00
DB-C541	Model D6SA	115	\$559.00
DB-C542	Model D7SA	135	\$553.00
DB-1033113	Model D-6C/D	496	\$1,182.00
DB-1054856	Adapter Kit Challenger 65, 70, 75, 85 Bolts to Back Challenger (Ears mounted to hanger, No Drawbar)	150	\$671.00
DB-1060808	DB Kit - Challenger w/o 3-pt.. Challenger 65, 70, 75, 85, 95	425	\$2,171.00
DB-1060704	DB Kit Challenger w/3-pt. Challenger 65, 70, 75, 85, 95 (uses Cat Hanger) PTO will not work with this DB when installed. Ears limit access to PTO.	310	\$1,812.00
DB-1060765	Models Challenger 35, 45, 55	141	\$571.00
DB-788	Drawbar Adapter, Converts back to Std. Double lip hitch	80	\$429.00
DB-788A	Drawbar Adapter complete with 2" drawpin & Pin Keeper	89	\$665.00

### AGCO Challenger Tractors

\*\*\*\* Internal Note \*\*\*\* Challenger is introducing a C-Series tractor that might require changes to the drawbar, 4-29-09 is in contact with AGCO to determine changes.

DB-1062794-01	Models: MT-645, MT-655, MT-665 (2) Ear, Drawbar only	113	\$618.00
DB-1066329	Models: MT-735, MT-745, MT-755, MT-765, (2) Ear, Drawbar only	122	\$524.00
DB-1066330	Models: MT-835, MT-845, MT-855, MT-865 MT-875, <b>Ag Version Tractor model.</b> Includes: one (4) Each drawbar and a <b>modified hanger bracket.</b>	670	\$2,588.00
	(This drawbar requires the factory support hanger to be removed and replaced with the provided hange with this drawbar)		
DB-1015	Models: MT-835, MT-845, MT-855, MT-865, MT-875 (4) Ear drawbar, <b>Special Application Tractor, Drawbar only,</b> Use factory hanger support	275	\$1,565.00
DB-1016	Models: MT-900-series Articulated Tractor <b>Special Application Tractor, Drawbar only,</b> Use factory hanger support	390	\$1,788.00

Prices & Specifications are subject to change without advanced notice.

All prices are in U.S. Dollars, F.O.B. Ashland, Wisconsin.  
Drawbars will only receive current Parts Level Discounts.

*Tractor Drawbars for Ashland Industries Direct-Mounted Earthmovers*

Replaces standard tractor Drawbars with heavy-duty earthmover Drawbars to receive the 3-way adjustable yoke style hitch. Some Drawbars will also come included with modified hanger brackets. These Drawbars will range from a two ear to a four ear horizontal 1-1/2" pinning configuration. Contact your local tractor dealer to fully understand the tractors warranty while pulling direct-mount earthmovers.

**FENDTAGCO**

<b>Ashland Part No.</b>	<b>Tractor Model Number</b>	<b>Weight</b>	<b>List Price</b>
DB-1002	918, 920, 924, 926	128	\$420.00
DB-788	Drawbar Adapter, Converts back to Std. Double lip hitch	80	\$429.00
DB-788A	Drawbar Adapter complete with 2" drawpin & Pin Keeper	89	\$665.00

Prices & Specifications are subject to change without advanced notice.  
All prices are in U.S. Dollars, F.O.B. Ashland, Wisconsin.  
Drawbars will only receive current Parts Level Discounts.

# FORD - New Holland

## Tractor Drawbars for Ashland Industries Direct-Mounted Earthmovers

Replaces standard tractor Drawbars with heavy-duty earthmover Drawbars to receive the 3-way adjustable yoke style hitch. Some Drawbars will also come included with modified hanger brackets. These Drawbars will range from a two ear to a four ear horizontal 1-1/2" pinning configuration. Contact your local tractor dealer to fully understand the tractors warranty while pulling direct-mount earthmovers.

### FORD-New Holland

Ashland Part No.	Application	Approx. Weight	Price
DB-1020455	Models 5000, 8000, 8600, 9000, 9600, 9700, TW5-35, TW20, TW30, 7610, 7710	95	\$424.00
DB-1060831	Models 8160, 8260, 8360, 8560	60	\$341.00
DB-1060765	"Genesis" Series 70 w/3-pt, Models 8670, 8770, 8870, 8970	141	\$571.00
DB-600117	T8000-series, <b>four</b> ear drawbar. Applicable to all countries (Note: North American std. version cat. 3 drawbar. <b>(uses 35mm belly-pin)</b> ) T8010, T8020, T8030, T8040, T8050		\$ to be determined
DB-600116	T8000 series North America with Heavy Duty optional category 4 drawbar, <b>(uses 44mm belly-pin)</b> similar to Case Magnum Series (only available in North America) Need to confirm with CNH about the HD cat 4 for NH. confirmed Case tractor, failed to ask about NH.		
DB-1062179-01	Models TG-210, TG-230, TG-255, TG-285	115	\$518.00
DB-1007	Buhler 2240 2290, 2335, 2375, 2360, 2425, (Drawbar & Hanger only) Ford, New Holland Versatile Models: 9480, 9680, 9880, 9482 9484, 9682, 9684 (with or without 3-pt)	615	\$2,794.00
DB-1066327	Model: TM110, TM120, TM130, TM140, TM155		\$510.00
DB-1061739	Model TJ-Series, 375, 425, 450, 500 Tractors	1084	\$2,824.00
DB-788	Drawbar Adapter, Converts back to Std. Double lip hitch	80	\$429.00
DB-788A	Drawbar Adapter complete with 2" drawpin & Pin Keeper	89	\$665.00
DB-1065710	(2) Ear DB for Models TM165, TM175, TM190		CALL FOR PRICING

Prices & Specifications are subject to change without advanced notice.  
All prices are in U.S. Dollars, F.O.B. Ashland, Wisconsin.  
Drawbars will only receive current Parts Level Discounts.

## Tractor Drawbars for Ashland Industries Direct-Mounted Earthmovers

Replaces standard tractor Drawbars with heavy-duty earthmover Drawbars to receive the 3-way adjustable yoke style hitch. Some Drawbars will also come included with modified hanger brackets. These Drawbars will range from a two ear to a four ear horizontal 1-1/2" pinning configuration. Contact your local tractor dealer to fully understand the tractors warranty while pulling direct-mount earthmovers.

Ashland Part No.	Application	Approx. Weight	Price
DB-C172-6	Models 700, 4520, 4620, (Long) 4630, 5010, 5020, 6030, 7020, 7520 Mounted Hyd. Pump	130	\$476.00
DB-C172-10	Models 8430, 8440, 8450, 8630, 40-Series, 50-Series	150	\$676.00
DB-C172	Models 700, 4520, 4620, 4630, 5010, 5020, 6030, 7020, 7520	140	\$441.00
DB-D473	Models 4040, 4240, 4440, 4450, 4455	85	\$324.00
DB-C907	Models 4560, 4640, 4650, 4755, 4760, 4840, 4850, 4955, 4960	177	\$565.00
DB-1023381	Models 2840, 2940	50	\$259.00
DB-1023382	Models 2020, 2240, 2440, 2640	50	\$247.00
DB-1027555	Model 8850	260	\$1,594.00
DB-1058801	Models 8560, 8760, 8960, 8570, 8870, 8970, 9100, 9120, 9200, 9220, 9300, 9320, 9400, 9420, 9520 (Ag Types)	356	\$1,405.00
Not Available yet	9520 (Scraper Type) Equip with HD Drawbar Support, Front Axle Support & Gudgeon (HD Center Hinge support) 16" shorter than Ag tractors.		
DB-1061132	Models 5200, 5300, 5400, 5500	70	\$359.00
DB-1060836	DB Weldment for 6000 Series, 6100, 6110, 6200, 6210, 6300, 6310, 6400, 6405, 6410, 6500, 6510, 6605 w/3-pt. Hitch	69	\$294.00
DB-1060702	DB Weldment for 7000 Series, 7200, 7210, 7220, 7400, 7410, 7420, 7600, 7700, 7800 w/3-pt. Hitch	90	\$524.00
DB-1060767-01	DB Weldment for 8000 Series w/3-pt. Thru S/N 009999, Models 8100, 8200, 8300 ONLY.	162	\$694.00
DB-1060649-01	DB Weldment for 8400 Series w/3-pt. Thru S/N 009999 Model 8400 ONLY. (1-1/4" Belly Pin)	165	\$765.00
DB-1060649-02	DB Weldment for 8000 Series w/3-pt. At S/N 010000 & up. Models 8100, 8200, 8300, 8400, 8300T, 8400T, 8110, 8210, 8310, 8410, 8120, 8220, 8320, 8320, 8420, 8430, (uses 33mm belly pin)	165	\$753.00
DB-1005	DB Weldment for 8520, 8530 (uses 38mm belly pin)	250	\$1,506.00
DB-1060847	DB Adapter Kit for "IND. JD DOZER" 450G, 455G, 550G, 555G, 650G w/JD T112606 DB	53	\$271.00
DB-1061742	DB Adapter Kit for "IND. JD DOZER" 750C / 850C with 90mm Clevis & 45mm Pin	60	\$371.00
DB-788	Drawbar Adapter, Converts back to Std. Double lip hitch	80	\$429.00
DB-788A	Drawbar Adapter complete with 2" drawpin & Pin Keeper	89	\$665.00
DB-1064265	(4) Ear DB for 9000 srs models (4WD) w/reg. Ag DB support (supersedes 1058801)		CALL FOR PRICING
DB-1065740	DB Weldment, 9300T, 9400T, 9320T, 9420T, 9520T, Tractor has double plated hanger as <b>shown below</b>		\$1,829.00
DB-1065740-01	DB Weldment, 9300T, 9400T, 9320T, 9420T, 9520T, with <b>wide</b> swing hanger support as <b>shown below</b>	815	\$2,259.00

Std Double plated rigid Hanger use DB-1065740

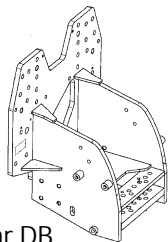

Wide Swing Support use DB-1065740-01

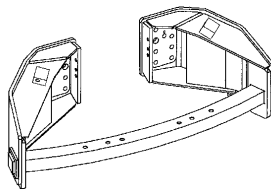

DB-1066600	(4) Ear DB (short) for 9020 srs (4WD) Scraper Tractor w/Hi-Flo on models 9320, 9420, 9520		CALL FOR PRICING
DB-1067348	(2) Ear DB for 7920		CALL FOR PRICING
DB-C171	For Models 3020, 4000, 4010, 4020, 4030, 4230, 4235, 4255, 4320, 4325, 4430, 4435	75	\$253.00

# KOMATSU & KUBOTA

## *Tractor Drawbars for Ashland Industries Direct-Mounted Earthmovers*

Replaces standard tractor Drawbars with heavy-duty earthmover Drawbars to receive the 3-way adjustable yoke style hitch. Some Drawbars will also come included with modified hanger brackets. These Drawbars will range from a two ear to a four ear horizontal 1-1/2" pinning configuration. Contact your local tractor dealer to fully understand the tractors warranty while pulling direct-mount earthmovers.

<b>Ashland Part No.</b>	<b>Application</b>		<b>Weight</b>	<b>Price</b>
		<b>KOMATSU</b>		
DB-1045559	Model D53A		325	\$1,135.00
DB-1044563	Model D85		366	\$1,924.00
		<b>KUBOTA</b>		
DB-1048097	Model M7500		38	\$165.00
DB-788	Drawbar Adapter, Converts back to Std. Double lip hitch		80	\$429.00
DB-788A	Drawbar Adapter complete with 2" drawpin & Pin Keeper		89	\$665.00

Prices & Specifications are subject to change without advanced notice.  
All prices are in U.S. Dollars, F.O.B. Ashland, Wisconsin.  
Drawbars will only receive current Parts Level Discounts.

*Tractor Drawbars for Ashland Industries Direct-Mounted Earthmovers*

Replaces standard tractor Drawbars with heavy-duty earthmover Drawbars to receive the 3-way adjustable yoke style hitch. Some Drawbars will also come included with modified hanger brackets. These Drawbars will range from a two ear to a four ear horizontal 1-1/2" pinning configuration. Contact your local tractor dealer to fully understand the tractors warranty while pulling direct-mount earthmovers.

**MASSEY FERGUSON**

<b>Ashland Part No.</b>	<b>Application</b>	<b>Weight</b>	<b>Price</b>
DB-C173	Models 1100, 1105, 1130, 1135, 1150, 1155 w/o Pressure Control	95	\$271.00
DB-C173-501	Models 1100, 1105, 1130, 1135, 1150, 1155 Western	95	\$288.00
DB-C174	Models 1100, 1105, 1130, 1135, 1150, 1155 w/ Pressure Control	95	\$394.00
DB-B240	Models 1500, 1800 - Drawbar Adapter	65	\$171.00
DB-D525	Models 1505, 1805 - Drawbar Adapter	60	\$488.00
DB-1060642	DB Weldment Models 2640, 3505	78	\$506.00
DB-D524	Models 2805, 2705, 2715	110	\$300.00
DB-1020583	Models 4840, 4880, 4900, 5200 w/o 3-pt. Hitch	110	\$749.00
DB-1021774	Models 4840, 4880, 4900, 5200 w/3-pt. Hitch	235	\$776.00
DB-1062794-01	Models 8260, 8270, 8280	113	\$618.00
DB-788	Drawbar Adapter, Converts back to Std. Double lip hitch	80	\$429.00
DB-788A	Drawbar Adapter complete with 2" drawpin & Pin Keeper	89	\$665.00
DB-1067295	(2) Ear DB for 8220, 8240, 8245, 8250	CALL FOR PRICING	

Prices & Specifications are subject to change without advanced notice.  
All prices are in U.S. Dollars, F.O.B. Ashland, Wisconsin.  
Drawbars will only receive current Parts Level Discounts.

# OLIVER

## *Tractor Drawbars for Ashland Industries Direct-Mounted Earthmovers*

Replaces standard tractor Drawbars with heavy-duty earthmover Drawbars to receive the 3-way adjustable yoke style hitch. Some Drawbars will also come included with modified hanger brackets. These Drawbars will range from a two ear to a four ear horizontal 1-1/2" pinning configuration. Contact your local tractor dealer to fully understand the tractors warranty while pulling direct-mount earthmovers.

### OLIVER

Ashland Part No.	Application	Weight	Price
DB-C195	Models 1850, 2050, 2150	105	\$265.00
DB-788	Drawbar Adapter, Converts back to Std. Double lip hitch	80	\$429.00
DB-788A	Drawbar Adapter complete with 2" drawpin & Pin Keeper	89	\$665.00

Prices & Specifications are subject to change without advanced notice.  
All prices are in U.S. Dollars, F.O.B. Ashland, Wisconsin.  
Drawbars will only receive current Parts Level Discounts.

# ROME TRACTOR

## *Tractor Drawbars for Ashland Industries Direct-Mounted Earthmovers*

Replaces standard tractor Drawbars with heavy-duty earthmover Drawbars to receive the 3-way adjustable yoke style hitch. Some Drawbars will also come included with modified hanger brackets. These Drawbars will range from a two ear to a four ear horizontal 1-1/2" pinning configuration. Contact your local tractor dealer to fully understand the tractors warranty while pulling direct-mount earthmovers.

### ROME TRACTORS

<b>Ashland Part No.</b>	<b>Application</b>	<b>Weight</b>	<b>Price</b>
DB-C914	Model 220	270	\$476.00
DB-C602	Model 320, 1975 Only	315	\$906.00
DB-C603	Models 320, 1976 -, 375, 450, 475, 600	315	\$865.00
DB-788	Drawbar Adapter, Converts back to Std. Double lip hitch	80	\$429.00
DB-788A	Drawbar Adapter complete with 2" drawpin & Pin Keeper	89	\$665.00

Prices & Specifications are subject to change without advanced notice.  
All prices are in U.S. Dollars, F.O.B. Ashland, Wisconsin.  
Drawbars will only receive current Parts Level Discounts.

# STEIGER

(Also see Case IH - Steiger)

## Tractor Drawbars for Ashland Industries Direct-Mounted Earthmovers

Replaces standard tractor Drawbars with heavy-duty earthmover Drawbars to receive the 3-way adjustable yoke style hitch. Some Drawbars will also come included with modified hanger brackets. These Drawbars will range from a two ear to a four ear horizontal 1-1/2" pinning configuration. Contact your local tractor dealer to fully understand the tractors warranty while pulling direct-mount earthmovers.

Ashland Part No.	Application	STEIGER (Prior to Case IH)	Approx. Weight	Price
DB-C525	Model Wildcat (210)		275	\$706.00
DB-1020671	Series 2 & 3, Bare Back, Models 103 ST 220 Bearcat, ST 250 Cougar, ST 270 Cougar, ST 251 Cougar, ST 310 Panther, ST 320 Panther, ST 325 Panther 104ST, 105ST, 106ST, 107ST, 108ST, 123ST		1170	\$2,082.00
DB-1024402	Series 2 & 3 ( ST only), with 3 Point Hitch Weldment, Bearcat ST(Series 3 Only), Cougar (2&3-ST), Panther (2&3-ST) Tigar (2&3 ST)		590	\$1,853.00
				
DB-D494	Model Tiger 450 - Drawbar Adapter		80	\$376.00
DB-1029322	Models 1325, 1360, 1400		827	\$1,947.00
DB-1024405	Series 3, Models 140 PT 350 Panther, 141 PT 225 Bearcat, 142 PT 250 Cougar, 143 PT 270 Cougar, 148 PTA 296 Panther, 149 PTA 297 Panther, 150 PTA 350 Panther, KM 280 series 4, Ford FW30, FW40, FW60 Fits Industrial Tractor - Less Fifth Wheel		315	\$1,759.00
DB-1045796	Model 1000 w/3-pt. Hitch w. adj. Drawbar & 3pt hitch		800	\$1,694.00
DB-1028573	Industrial Model w/ Fifth Wheel		439	\$1,306.00
DB-788	Drawbar Adapter, Converts back to Std. Double lip hitch		80	\$429.00
DB-788A	Drawbar Adapter complete with 2" drawpin & Pin Keeper		89	\$665.00

Prices & Specifications are subject to change without advanced notice.  
All prices are in U.S. Dollars, F.O.B. Ashland, Wisconsin.  
Drawbars will only receive current Parts Level Discounts.

*Tractor Drawbars for Ashland Industries Direct-Mounted Earthmovers*

Replaces standard tractor Drawbars with heavy-duty earthmover Drawbars to receive the 3-way adjustable yoke style hitch. Some Drawbars will also come included with modified hanger brackets. These Drawbars will range from a two ear to a four ear horizontal 1-1/2" pinning configuration. Contact your local tractor dealer to fully understand the tractors warranty while pulling direct-mount earthmovers.

		<b>WHITE</b>		
<b>Ashland Part No.</b>	<b>Application</b>		<b>Weight</b>	<b>Price</b>
DB-1047467	Models 2-180, 4-180			\$215.00
DB-1021787	Models 2-135, 2-155		140	\$295.00
DB-1028410	Model 4-150		150	\$480.00
DB-1062794-01	Model 8610, 8710, 8810		112	\$618.00
DB-1067295	(2) Ear Drawbar for models 8310, 8410, 8510		CALL FOR PRICING	
DB-788	Drawbar Adapter, Converts back to Std. Double lip hitch		80	\$429.00
DB-788A	Drawbar Adapter complete with 2" drawpin & Pin Keeper		89	\$665.00

Prices & Specifications are subject to change without advanced notice.  
 All prices are in U.S. Dollars, F.O.B. Ashland, Wisconsin.  
 Drawbars will only receive current Parts Level Discounts.

# **WOODS & COPELAND / ROME**

## *Tractor Drawbars for Ashland Industries Direct-Mounted Earthmovers*

Replaces standard tractor Drawbars with heavy-duty earthmover Drawbars to receive the 3-way adjustable yoke style hitch. Some Drawbars will also come included with modified hanger brackets. These Drawbars will range from a two ear to a four ear horizontal 1-1/2" pinning configuration.

### **WOODS & COPELAND / ROME**

<b>Ashland Part No.</b>	<b>Application</b>	<b>Weight</b>	<b>Price</b>
DB-C914	Model 220	270	\$476.00
DB-C602	Model 320	315	\$906.00
DB-C603	Models 450, 475	315	\$865.00
DB-788	Drawbar Adapter, Converts back to Std. Double lip hitch	80	\$429.00
DB-788A	Drawbar Adapter complete with 2" drawpin & Pin Keeper	89	\$665.00

Prices & Specifications are subject to change without advanced notice.  
All prices are in U.S. Dollars, F.O.B. Ashland, Wisconsin.  
Drawbars will only receive current Parts Level Discounts.

# VERSATILE

## *Tractor Drawbars for Ashland Industries Direct-Mounted Earthmovers*

Replaces standard tractor Drawbars with heavy-duty earthmover Drawbars to receive the 3-way adjustable yoke style hitch. Some Drawbars will also come included with modified hanger brackets. These Drawbars will range from a two ear to a four ear horizontal 1-1/2" pinning configuration. Contact your local tractor dealer to fully understand the tractors warranty while pulling direct-mount earthmovers.

### VERSATILE

<b>Ashland Part No.</b>	<b>Tractor Model Number</b>	<b>Weight</b>	<b>List Price</b>
DB-1031074	Model 1150	827	\$1,994.00
DB-D523	Models 875, 900, 950, 895, 800 Series 2 (1-1/2" Belly Pin)	242	\$759.00
DB-C544	Models 700, 850, 835	220	\$553.00
DB-1041952	Model 955	547	\$1,929.00
DB-1041947	Model 955 w/3-pt. Hitch	481	\$865.00
DB-1048698	Models 836, 846, 856, 876 (1-1/4" Belly Pin)	218	\$594.00
DB-1048914	Models 936, 946, 956, 976 (2" belly Pin)	672	\$1,382.00
DB-1060768	"Versatile" Series 80 w/ or w/o 3-pt. Models 9480, 9680, 9880 9482, 9682, 9484, 9684 tractors	639	\$1,788.00
DB-788	Drawbar Adapter, Converts back to Std. Double lip hitch	80	\$429.00
DB-788A	Drawbar Adapter complete with 2" drawpin & Pin Keeper	89	\$665.00

Also See Bueller Versatile and/or Ford New Holland pages

Prices & Specifications are subject to change without advanced notice.  
All prices are in U.S. Dollars, F.O.B. Ashland, Wisconsin.  
Drawbars will only receive current Parts Level Discounts.

# VOLVO

New Heavy Duty "Quick Hitch" makes connecting & Disconnecting the I-180TS2 to the Volvo T450D effortless. Once the hitch is installed on the hauler there are no pins to align and no tools needed to connect or disconnect the I-180Ts2.

The four ear configuration provides plenty of support for the hitch pin, the heavy duty latch and lock pin provide all the security

to keep the scraper connected even in the toughest applications.

The New "Quick Hitch" is available through Ashland Industries Parts Department for those T450D's already in your Fleets.

Also available through the Volvo Sales Order Team when ordering a new T450D and Ashland I-180TS2.

## VOLVO

Ashland Part No.	Tractor Model Number	Weight	List Price
DB-1021	Quick Hitch Drawbar for T450D Generation This drawbar uses both the back mounting bracket and bellypin	400	\$4,730.00

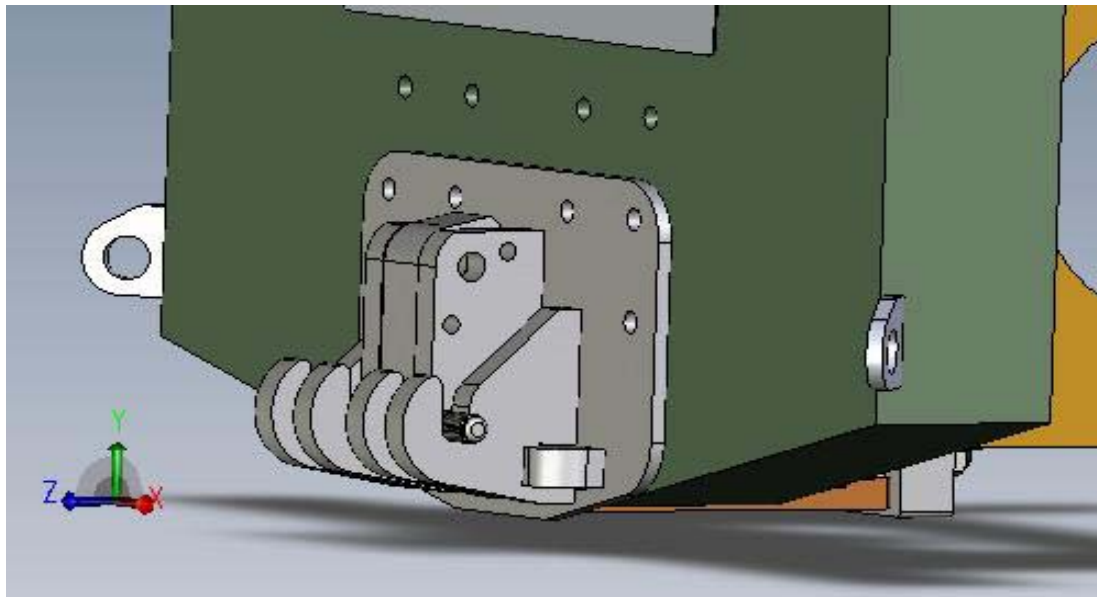

Prices & Specifications are subject to change without advanced notice.  
All prices are in U.S. Dollars, F.O.B. Ashland, Wisconsin.  
Drawbars will only receive current Parts Level Discounts.